

TEMAX™ CB-9

These Rugged Elastomer bumpers have an innovative dual spring rate and meet the minimum existing OSHA and CMAA standards for Bridge Crane Applications. Additionally, the dual spring rates have made them ideal for High Load Suspension Jounce Stops. Bumpers are easily mounted with a single socket head cap screw.

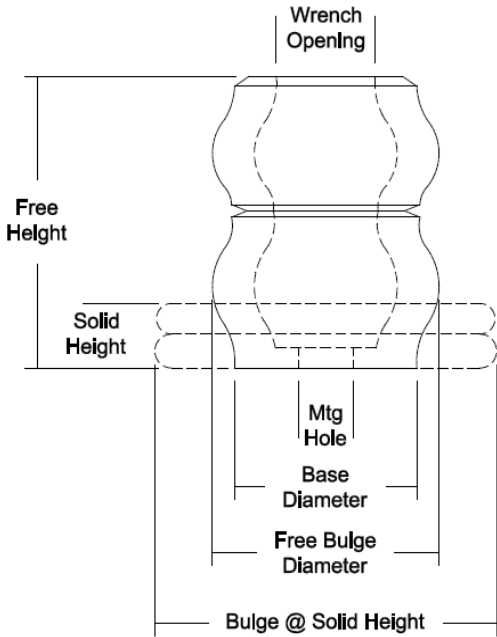

Physical Specifications

Energy Capacity	6144 Ft-lbs
Maximum Force	186,500 lbs
Free Height	4.63 ± 0.120 in
Free Bulge	5.75 ± 0.180 in
Wrench Opening	1.55 ± 0.060 in
Base Diameter	3.90 ± 0.050 in
Mounting Hole	0.80 ± 0.030 in
Solid Height	2.00 ± 0.005 in
Bulge @ Solid Height	7.50 ± 0.020 in
Base Thickness	0.500 ± 0.020 in
Weight	3.4 lbs.
Mounting Screw	3/4-10 SHCS

Typical Applications

- Jounce Stops on High Load Suspension Systems
- Maintenance Free Emergency Stops on Lift Systems
- Cushion Stops on Overhead Cranes
- Maintenance Free Shock Absorbers on Material Handling Systems
- Saddle Block Cushions & Boom Bumper Blocks on Mining Equipment
- Elastomer Shock Absorption on Lumber Mill De-Barking Machines

Graphs are illustrative only.

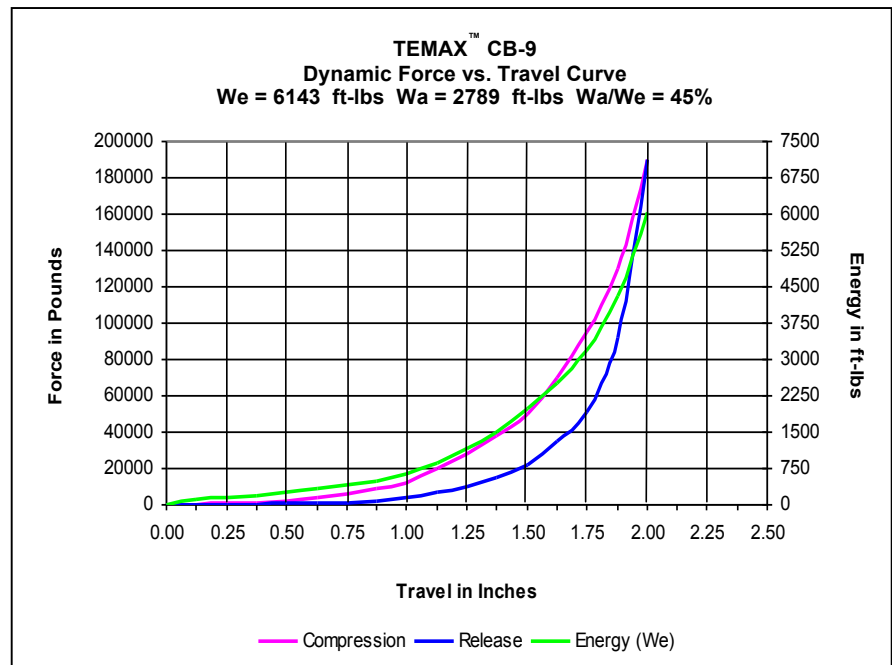
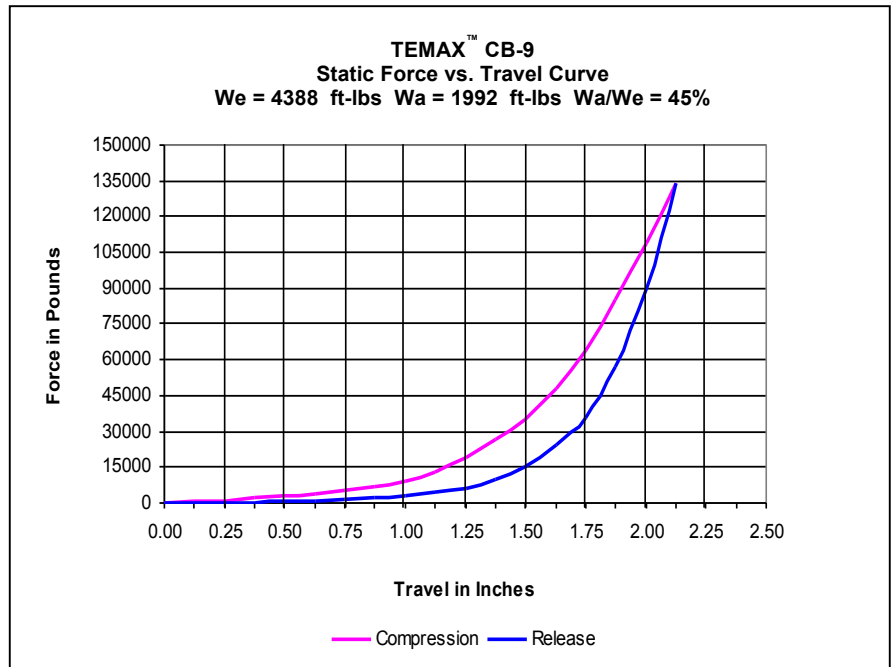

Dynamic Energy (We) is the Energy Capacity of the Bumper with respect to Displacement or Compression of the Bumper